

ACCESSOIRES

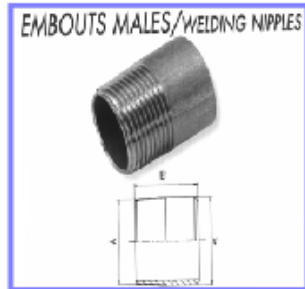

AISI 316 L

FILETAGE GAZ (NFE 03004) OU (NPT)

REF	DN	A	B	
EM-1/8	5	1/8	30	
EM-1/4	8	1/4	30	
EM-3/8	10	3/8	35	
EM-1/2	15	1/2	35	
EM-3/4	20	3/4	35	
EM-1	25	1	40	
EM-11/4	32	11/4	40	
EM-11/2	40	11/2	45	
EM-2	50	2	50	
EM-21/2	65	21/2	60	
EM-3	80	3	60	

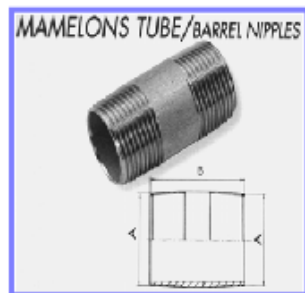

AISI 316 L

FILETAGE GAZ (NFE 03004) OU (NPT)

REF	DN	A	B	
EMM-1/8	5	1/8	40	
EMM-1/4	8	1/4	50	
EMM-3/8	10	3/8	50	
EMM-1/2	15	1/2	50	
EMM-3/4	20	3/4	50	
EMM-1	25	1	55	
EMM-11/4	32	11/4	60	
EMM-11/2	40	11/2	60	
EMM-2	50	2	70	



AISI 316 L

FILETAGE GAZ (NFE 03004) OU (NPT)

REF	DN	A	B	C	E
MAM-1/8	5	1/8	25	12	5
MAM-1/4	8	1/4	31	14	7
MAM-3/8	10	3/8	34	19	11
MAM-1/2	15	1/2	40	22	14
MAM-3/4	20	3/4	44	27	19
MAM-1	25	1	50	35	24
MAM-11/4	32	11/4	54	46	31
MAM-11/2	40	11/2	54	51	37
MAM-2	50	2	64	64	47
MAM-21/2	65	21/2	68	76	64
MAM-3	80	3	72	92	79



AISI 316 L

FILETAGE GAZ (NFE 03005) OU (NPT)

REF	DN	A	B	D
EF-1/8	5	1/8	25	14
EF-1/4	8	1/4	30	16
EF-3/8	10	3/8	30	20
EF-1/2	15	1/2	30	26
EF-3/4	20	3/4	30	35
EF-1	25	1	35	40
EF-11/4	32	11/4	35	49
EF-11/2	40	11/2	40	54
EF-2	50	2	40	69

ACCESSOIRES



AISI 316 L

FILETAGE GAZ CYL (NFE 03005)

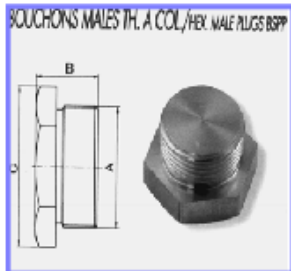

REF	DN	A	B	C
BM-1/8	5	1/8	15	14
BM-1/4	8	1/4	15	17
BM-3/8	10	3/8	17	21
BM-1/2	15	1/2	20	27
BM-3/4	20	3/4	22	32
BM-1	25	1	22	41
BM-1 1/4	32	1 1/4	25	50
BM-1 1/2	40	1 1/2	30	55
BM-2	50	2	30	70

AISI 316 L

FILETAGE GAZ (NFE 03004)



REF	DN	A	B	C
BM-1/8-GC	5	1/8	19	12
BM-1/4-GC	8	1/4	19	14
BM-3/8-GC	10	3/8	21	19
BM-1/2-GC	15	1/2	24	22
BM-3/4-GC	20	3/4	27	27
BM-1-GC	25	1	30	35
BM-1 1/4-GC	32	1 1/4	32	46
BM-1 1/2-GC	40	1 1/2	32	50
BM-2-GC	50	2	38	63
BM-2 1/2-GC	65	2 1/2	42	78
BM-3-GC	80	3	46	92

AISI 316 L

FILETAGE GAZ (NFE 03005)

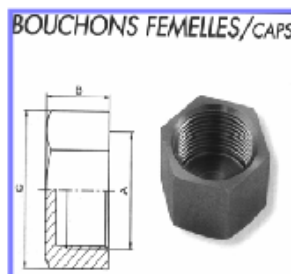

REF	DN	A	B	C
BF-1/8	5	1/8	15	14
BF-1/4	8	1/4	15	17
BF-3/8	10	3/8	17	21
BF-1/2	15	1/2	20	27
BF-3/4	20	3/4	22	32
BF-1	25	1	22	41
BF-1 1/4	32	1 1/4	25	50
BF-1 1/2	40	1 1/2	30	55
BF-2	50	2	30	70
BF-2 1/2	65	2 1/2	39	83
BF-3	80	3	42	98

AISI 316 L

FILETAGE GAZ (NFE 03004)



REF	DN	A	B	C
BHC-5-GC	5	1/8	8	5
BHC-8-GC	8	1/4	11	6
BHC-12-GC	10	3/8	12	8
BHC-15-GC	15	1/2	15	10
BHC-20-GC	20	3/4	17	12
BHC-26-GC	25	1	19	12
BHC-33-GC	32	1 1/4	22	12
BHC-40-GC	40	1 1/2	22	17

ACCESSOIRES

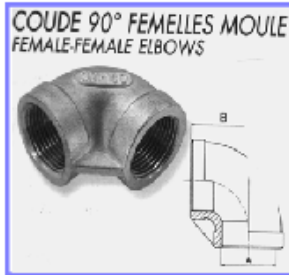

REF	DN	A	B
CEF-5	5	1/8	18
CEF-8	8	1/4	20
CEF-12	10	3/8	24
CEF-15	15	1/2	28
CEF-20	20	3/4	33
CEF-26	25	1	38
CEF-33	32	1 1/4	44
CEF-40	40	1 1/2	49
CEF-50	50	2	57
CEF-65	65	2 1/2	69
CEF-80	80	3	78

AISI 316 L FILETAGE GAZ (NFE 03004) OU (NPT)



REF	DN	A	B	C
CMF-5	5	1/8	25	18
CMF-8	8	1/4	30	20
CMF-12	10	3/8	35	24
CMF-15	15	1/2	41	28
CMF-20	20	3/4	48	33
CMF-26	25	1	54	38
CMF-33	32	1 1/4	62	44
CMF-40	40	1 1/2	68	49
CMF-50	50	2	83	57
CMF-65	65	2 1/2	88	69
CMF-80	80	3	115	78

AISI 316 L FILETAGE GAZ (NFE 03005) OU (NPT)



REF	DN	A	B
TEF-5	5	1/8	18
TEF-8	8	1/4	20
TEF-12	10	3/8	24
TEF-15	15	1/2	28
TEF-20	20	3/4	33
TEF-26	25	1	38
YEF-33	32	1 1/4	44
TEF-40	40	1 1/2	49
TEF-50	50	2	57
TEF-65	65	2 1/2	69
TEF-80	80	3	78

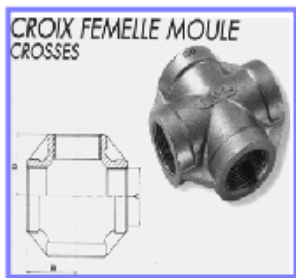

AISI 316 L FILETAGE GAZ (NFE 03005) OU (NPT)

REF	DN	A	B
CRF-8	8	1/4	20
CRF-12	12	3/8	24
CRF-15	15	1/2	28
CRF-20	20	3/4	33
CRF-26	25	1	38
CRF-33	32	1 1/4	44
CRF-40	40	1 1/2	49
CRF-50	50	2	57

ACCESSOIRES



REDUCTION MALE / FEMELLE

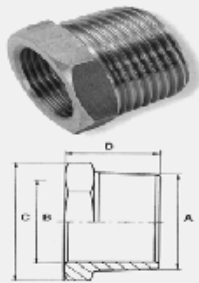

AISI 316 L

FILETAGE GAZ (NFE 03004)
POSSIBILITE FILETAGE (NPT)

REF	A	B	C	D
RMF-1/4-1/8	1/4	1/8	14	19
RMF-3/8-1/8	3/8	1/8	19	21
RMF-3/8-1/4	3/8	1/4	19	21
RMF-1/2-1/8	1/2	1/8	22	24
RMF-1/2-1/4	1/2	1/4	22	24
RMF-1/2-3/8	1/2	3/8	22	24
RMF-3/4-1/8	3/4	1/8	27	27
RMF-3/4-1/4	3/4	1/4	27	27
RMF-3/4-3/8	3/4	3/8	27	27
RMF-3/4-1/2	3/4	1/2	27	27
RMF-1-1/4	1	1/4	35	30
RMF-1-3/8	1	3/8	35	30
RMF-1-1/2	1	1/2	35	30
RMF-1-3/4	1	3/4	35	30
RMF-11/4-1/2	11/4	1/2	46	32
RMF-11/4-3/4	11/4	3/4	46	32
RMF-11/4-1	11/4	1	46	32
RMF-11/2-1/2	11/2	1/2	50	32
RMF-11/2-3/4	11/2	3/4	50	32
RMF-11/2-1	11/2	1	50	32
RMF-11/2-11/4	11/2	11/4	50	32
RMF-2-1	2	1	63	38
RMF-2-11/4	2	11/4	63	38
RMF-2-11/2	2	11/2	63	38
RMF-21/2/2	21/2	2	76	38

ECROUX HEXAGONAUX/HEXAGON NUTS

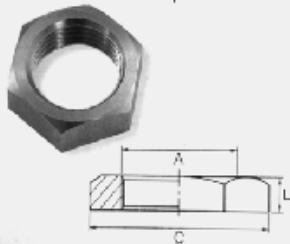

AISI 316 L

FILETAGE GAZ (NFE 03005)

REF	DN	A	C	L
EH-8	8	1/4	22	6
EH-12	10	3/8	27	7
EH-15	15	1/2	29	8
EH-20	20	3/4	35	9
EH-26	25	1	46	10
EH-33	32	11/4	56	11
EH-40	40	11/2	63	12
EH-50	50	2	76	13

EMBOUT MALE CANNELE/HEXAGON MALE HOSE NIPPLE

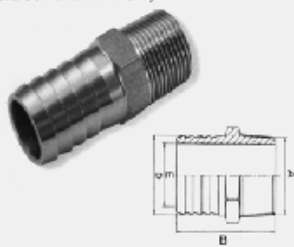

AISI 316 L

FILETAGE GAZ (NFE 03004)

REF	DN	A	B	D	E
EC-13-1/4M	8	1/4	49	13	8
EC-17-3/8M	10	3/8	53	16.8	12
EC-19-1/2M	15	1/2	58	21	15
EC-26-3/4M	20	3/4	65	26.3	20
EC-33-1M	25	1	67	33	25
EC-42-11/4M	32	11/4	70	41.8	33
EC-48-11/2M	40	11/2	70	47.5	38
EC-60-2M	50	2	72	59.5	50

ACCESSOIRES



REDUCTIONS FEMELLE-FEMELLE
FEMALE-FEMALE REDUCERS

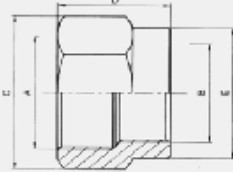

AISI 316 L

FILETAGE GAZ (NFE 03005) POSSIBILITE FILETAGE (NPT)

REF	A	B	C	D	E
RFF-1/4-1/8	1/4	1/8	17	23	15
RFF-3/8-1/8	3/8	1/8	22	27	20
RFF-3/8-1/4	3/8	1/4	22	27	20
RFF-1/2-1/8	1/2	1/8	27	31	25
RFF-1/2-1/4	1/2	1/4	27	31	25
RFF-1/2-3/8	1/2	3/8	27	31	25
RFF-3/4-1/8	3/4	1/8	35	34	25
RFF-3/4-1/4	3/4	1/4	35	34	25
RFF-3/4-3/8	3/4	3/8	35	34	25
RFF-3/4-1/2	3/4	1/2	35	34	33
RFF-1-1/4	1	1/4	40	33	25
RFF-1-3/8	1	3/8	40	33	25
RFF-1-1/2	1	1/2	40	35	33
RFF-1-3/4	1	3/4	40	36	38
RFF-1 1/4-1/2	1 1/4	1/2	50	34	33
RFF-1 1/4-3/4	1 1/4	3/4	50	34	38
RFF-1 1/4-1	1 1/4	1	50	35	48
RFF-1 1/2-1/2	1 1/2	1/2	55	34	33
RFF-1 1/2-3/4	1 1/2	3/4	55	34	38
RFF-1 1/2-1	1 1/2	1	55	39	48
RFF-1 1/2-1 1/4	1 1/2	1 1/4	55	39	54
RFF-2-1	2	1	70	39	48
RFF-2-1 1/4	2	1 1/4	70	41	54
RFF-2-1 1/2	2	1 1/2	70	43	66
RFF-2 1/2-2	2 1/2	2	85	75	68

COURBE 90° MALE/MALE 316 TI/ELBOWS 90° MALE/MALE LONG RADIUS



AISI 316 TI

FILETAGE GAZ (NFE 03004)

REF	DN	A	L
CGM-8-GC	8	1/4	60
CGM-12-GC	10	3/8	70
CGM-15-GC	15	1/2	80
CGM-20-GC	20	3/4	100
CGM-26-GC	25	1	120
CGM-33-GC	32	1 1/4	140
CGM-40-GC	40	1 1/2	160
CGM-50-GC	50	2	190

ACCESSOIRES



REDUCTIONS MALE-MALE MALE-MALE REDUCERS

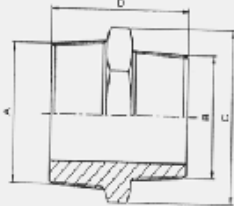

AISI 316 L

FILETAGE GAZ (NFE 03004) POSSIBILITE FILETAGE (NPT)

REF	A	B	C	D	
RMM-1/4-1/8	1/4	1/8	14	31	
RMM-3/8-1/8	3/8	1/8	19	33	
RMM-3/8-1/4	3/8	1/4	19	34	
RMM-1/2-1/8	1/2	1/8	22	36	
RMM-1/2-1/4	1/2	1/4	22	40	
RMM-1/2-3/8	1/2	3/8	22	40	
RMM-3/4-1/8	3/4	1/8	27	40	
RMM-3/4-1/4	3/4	1/4	27	43	
RMM-3/4-3/8	3/4	3/8	27	44	
RMM-3/4-1/2	3/4	1/2	27	44	
RMM-1-1/4	1	1/4	35	44	
RMM-1-3/8	1	3/8	35	46	
RMM-1-1/2	1	1/2	35	47	
RMM-1-3/4	1	3/4	35	50	
RMM-1 1/4-1/2	1 1/4	1/2	46	51	
RMM-1 1/4-3/4	1 1/4	3/4	46	51	
RMM-1 1/4-1	1 1/4	1	46	54	
RMM-1 1/2-3/4	1 1/2	3/4	50	52	
RMM-1 1/2-1	1 1/2	1	50	52	
RMM-1 1/2-1 1/4	1 1/2	1 1/4	50	54	
RMM-2-1 1/4	2	1 1/4	63	60	
RMM-2-1 1/2	2	1 1/2	63	64	
RMM-2 1/2-2	2 1/2	2	76	68	

REDUCTION FEMELLE / MALE

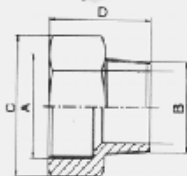

AISI 316 L

FILETAGE GAZ (NFE 03004) POSSIBILITE FILETAGE (NPT)

REF	A	B	C	D	
RFM-1/4-1/8	1/4	1/8	17	23	
RFM-3/8-1/8	3/8	1/8	22	27	
RFM-3/8-1/4	3/8	1/4	22	27	
RFM-1/2-1/4	1/2	1/4	27	31	
RFM-1/2-3/8	1/2	3/8	27	31	
RFM-3/4-1/4	3/4	1/4	35	31	
RFM-3/4-3/8	3/4	3/8	35	33	
RFM-3/4-1/2	3/4	1/2	35	37	
RFM-1-1/2	1	1/2	41	40	
RFM-1-3/4	1	3/4	41	41	
RFM-1 1/4-3/4	1 1/4	3/4	50	43	
RFM-1 1/4-1	1 1/4	1	50	46	
RFM-1 1/2-1	1 1/2	1	55	47	
RFM-1 1/2-1 1/4	1 1/2	1 1/4	55	49	
RFM-2-1 1/4	2	1 1/4	70	53	
RFM-2-1 1/2	2	1 1/2	70	57	